

Charlie Colfield
The Forbidden Fruit
22 Grand Parade
St Leonard's On Sea
TN37 6DN

21st April 2022

To whom it may concern,

This is a letter to add to the brief description of the licence application to explain what our business plans are. We will primarily be a place that people will come for drinks and entertainment. We will start introducing food as we head into the summer so we will be more of a restaurant/bar in the day and more of a bar in the evenings. We have live music and cabaret at the weekends and quizzes and social events during the week.

The area in the basement will be primarily used at the weekend for dancing and drinks. We plan to have amplified music as well as live music in this space. We can then use this area to play music through to our closing time and we can have music at a quieter level on the ground floor of the bar.

The area would also be used for some social and corporate events throughout the week. Using the basement area will allow us to move some of the amplified music downstairs which will cause less of a potential inconvenience to the people living in the flats above the ground floor bar. We now occupy one of the flats above the bar and have a member of staff occupying another of the flats so we have already alleviated what may have been a potential problem. All that being said, we have been open almost 8 months and we have had no noise complaints from any of our neighbours.

The basement will be used for plays, films, live music, recorded music, performance of dance, entertainment similar to live, recorded music and dance in the form of DJ/disco. This will not be limited to the basement only and will still also take place on the ground floor bar level.

We potentially plan on having late night refreshment for customers in the form of hot food for consumption on the premises and for customers to takeaway hot food that drop in or that are passing. Although we have no immediate plans to provide late night refreshments currently, we would like to put it in the application so we are able to provide such a service if we later decide to.

Sincerely,

Charlie James Colfield

Application to vary a premises licence under the Licensing Act 2003

PLEASE READ THE FOLLOWING INSTRUCTIONS FIRST

Before completing this form please read the guidance notes at the end of the form. If you are completing this form by hand please write legibly in block capitals. In all cases ensure that your answers are inside the boxes and written in black ink. Use additional sheets if necessary.

You may wish to keep a copy of the completed form for your records.

~~I/We~~ **CHARLIE COLFIELD**

(Insert name(s) of applicant)

being the premises licence holder, apply to vary a premises licence under section 34 of the Licensing Act 2003 for the premises described in Part 1 below

Premises licence number	HOP50304
-------------------------	----------

Part 1 – Premises Details

Postal address of premises or, if none, ordnance survey map reference or description			
THE FORBIDDEN FRUIT 22 GRAND PARADE			
Post town	ST LEONARDS ON SEA	Postcode	TN39 6DN

Telephone number at premises (if any)	01424 864160
Non-domestic rateable value of premises	£ 8,400

Part 2 – Applicant details

Daytime contact telephone number	[REDACTED]
E-mail address (optional)	[REDACTED]
Current postal address if different from premises address	[REDACTED]
Post town	[REDACTED]

Part 3 - Variation

WK 202112219

Rec 30005324 22/04/22.

Rec 22/04/22

Ends 20/05/22.

Please tick as appropriate

Do you want the proposed variation to have effect as soon as possible?

Yes

No

If not, from what date do you want the variation to take effect?

DD		MM		YYYY			
<input type="text"/>	<input type="text"/>	<input type="text"/>	<input type="text"/>	<input type="text"/>	<input type="text"/>	<input type="text"/>	<input type="text"/>

Do you want the proposed variation to have effect in relation to the introduction of the late night levy? (Please see guidance note 1) Yes No

Please describe briefly the nature of the proposed variation (Please see guidance note

2) THIS VARIATION IS BEING MADE TO INCLUDE THE BASEMENT AREA OF THE PREMISES. THIS AREA WILL MOSTLY BE USED AT THE WEEKENDS FOR LIVE MUSIC, DANCING AND DJ PERFORMANCE.

THERE WILL BE SOME SLIGHT CHANGES TO SOME OF THE LICENSABLE ACTIVITIES ALSO.

WE ARE A BAR + RESTAURANT WITH SEATING THROUGHOUT THE FRONT SECTION WITH EXTRA SEATING UP THE STAIRS TOWARDS THE BACK PAST THE TOILETS. KITCHEN AREA LOCATED THROUGH THE DOOR TO THE REAR OF THE SEATING AREA. STAFF AREA IS LOCATED ON THE UPPER MEZANINE LEVEL.

BASEMENT AREA TO BE USED AS A FUNCTION AREA WITH MORE TOILETS
BASEMENT ALSO USED FOR BEER STORE AND OTHER STORAGE AREAS.

CONSUMPTION OF OFF-SUPPLIES WILL BE IMMEDIATELY OUTSIDE THE GROUND FLOOR ENTRANCE TO THE PREMISES.

If your proposed variation would mean that 5,000 or more people are expected to attend the premises at any one time, please state the number expected to attend:

Part 4 Operating Schedule

Please complete those parts of the Operating Schedule below which would be subject to change if this application to vary is successful.

Provision of regulated entertainment (Please see guidance note 3) Please tick all that apply

- a) plays (if ticking yes, fill in box A)
- b) films (if ticking yes, fill in box B)
- c) indoor sporting events (if ticking yes, fill in box C)
- d) boxing or wrestling entertainment (if ticking yes, fill in box D)
- e) live music (if ticking yes, fill in box E)
- f) recorded music (if ticking yes, fill in box F)
- g) performances of dance (if ticking yes, fill in box G)
- h) anything of a similar description to that falling within (e), (f) or (g) (if ticking yes, fill in box H)

Provision of late night refreshment (if ticking yes, fill in box I)

Supply of alcohol (if ticking yes, fill in box J)

In all cases complete boxes K, L and M

A

Plays Standard days and timings (please read guidance note 8)			<u>Will the performance of a play take place indoors or outdoors or both – please tick</u> (please read guidance note 4)	Indoors	<input checked="" type="checkbox"/>
				Outdoors	<input type="checkbox"/>
				Both	<input type="checkbox"/>
Day	Start	Finish			
Mon	10:00	01:00	<u>Please give further details here</u> (please read guidance note 5) PLAYS + PANTOMIMES USING A STAGE AND AMPLIFIED MUSIC		
Tue	10:00	01:00			
Wed	10:00	01:00	<u>State any seasonal variations for performing plays</u> (please read guidance note 6)		
Thur	10:00	01:00			
Fri	10:00	02:00	<u>Non standard timings. Where you intend to use the premises for the performance of plays at different times to those listed in the column on the left, please list</u> (please read guidance note 7) CHRISTMAS EVE + NEW YEARS EVE 10:00 - 03:00		
Sat	09:00	02:00			
Sun	09:00	02:00			

B

Films Standard days and timings (please read guidance note 8)			<u>Will the exhibition of films take place indoors or outdoors or both – please tick</u> (please read guidance note 4)	Indoors	<input checked="" type="checkbox"/>
				Outdoors	<input type="checkbox"/>
				Both	<input type="checkbox"/>
Day	Start	Finish	<u>Please give further details here</u> (please read guidance note 5)		
Mon	10:00	01:00			
Tue	10:00	01:00	<u>State any seasonal variations for the exhibition of films</u> (please read guidance note 6)		
Wed	10:00	01:00			
Thur	10:00	02:00	<u>Non standard timings. Where you intend to use the premises for the exhibition of films at different times to those listed in the column on the left, please list</u> (please read guidance note 7)		
Fri	10:00	02:00			
Sat	09:00	02:00	CHRISTMAS EVE + NEW YEARS EVE 10:00 - 03:00		
Sun	09:00	02:00			

C

Indoor sporting events Standard days and timings (please read guidance note 8)			<u>Please give further details</u> (please read guidance note 5)
Day	Start	Finish	
Mon			<u>State any seasonal variations for indoor sporting events</u> (please read guidance note 6)
Tue			
Wed			<u>Non standard timings. Where you intend to use the premises for indoor sporting events at different times to those listed in the column on the left, please list</u> (please read guidance note 7)
Thur			
Fri			
Sat			
Sun			

D

Boxing or wrestling entertainments Standard days and timings (please read guidance note 8)			<u>Will the boxing or wrestling entertainment take place indoors or outdoors or both – please tick</u> (please read guidance note 4)	Indoors	<input type="checkbox"/>
				Outdoors	<input type="checkbox"/>
				Both	<input type="checkbox"/>
Day	Start	Finish	<u>Please give further details here</u> (please read guidance note 5)		
Mon					
Tue			<u>State any seasonal variations for boxing or wrestling entertainment</u> (please read guidance note 6)		
Wed					
Thur			<u>Non standard timings. Where you intend to use the premises for boxing or wrestling entertainment at different times to those listed in the column on the left, please list</u> (please read guidance note 7)		
Fri					
Sat					
Sun					

E

Live music Standard days and timings (please read guidance note 8)			Will the performance of live music take place indoors or outdoors or both – please tick (please read guidance note 4)	Indoors	<input checked="" type="checkbox"/>
				Outdoors	<input type="checkbox"/>
				Both	<input type="checkbox"/>
Day	Start	Finish	Please give further details here (please read guidance note 5)		
Mon	10:00	01:00			
			AMPLIFIED MUSIC		
Tue	10:00	01:00			
			State any seasonal variations for the performance of live music (please read guidance note 6)		
Wed	10:00	01:00			
Thur	10:00	02:00	Non standard timings. Where you intend to use the premises for the performance of live music at different times to those listed in the column on the left, please list (please read guidance note 7)		
Fri	10:00	02:00			
Sat	09:00	02:00	CHRISTMAS EVE + NEW YEARS EVE		
Sun	09:00	02:00	10:00 - 03:00		

F

Recorded music Standard days and timings (please read guidance note 8)			<u>Will the playing of recorded music take place indoors or outdoors or both – please tick</u> (please read guidance note 4)	Indoors	<input checked="" type="checkbox"/>
				Outdoors	<input type="checkbox"/>
				Both	<input type="checkbox"/>
Day	Start	Finish	<u>Please give further details here</u> (please read guidance note 5) AMPLIFIED MUSIC		
Mon	10:00	01:00			
Tue	10:00	01:00	<u>State any seasonal variations for the playing of recorded music</u> (please read guidance note 6)		
Wed	10:00	01:00			
Thur	10:00	02:00			
Fri	10:00	02:00			
			<u>Non standard timings. Where you intend to use the premises for the playing of recorded music at different times to those listed in the column on the left, please list</u> (please read guidance note 7)		
Sat	09:00	02:00	CHRISTMAS EVE + NEW YEARS EVE 10:00 – 03:00		
Sun	09:00	02:00			

G

Performances of dance Standard days and timings (please read guidance note 8)			Will the performance of dance take place indoors or outdoors or both – please tick (please read guidance note 4)	Indoors	<input checked="" type="checkbox"/>
				Outdoors	<input type="checkbox"/>
				Both	<input type="checkbox"/>
Day	Start	Finish	Please give further details here (please read guidance note 5)		
Mon	10:00	01:00			
Tue	10:00	01:00			
Wed	10:00	01:00	State any seasonal variations for the performance of dance (please read guidance note 6)		
Thur	10:00	02:00			
Fri	10:00	02:00	Non standard timings. Where you intend to use the premises for the performance of dance at different times to those listed in the column on the left, please list (please read guidance note 7)		
Sat	09:00	02:00			
Sun	09:00	02:00			

CHRISTMAS EVE + NEW YEARS EVE
10:00 - 03:00

H

<p>Anything of a similar description to that falling within (e), (f) or (g) Standard days and timings (please read guidance note 8)</p>			<p>Please give a description of the type of entertainment you will be providing DISCO PERFORMANCE DANCING</p>		
Day	Start	Finish	<p>Will this entertainment take place indoors or outdoors or both – please tick (please read guidance note 4)</p>	Indoors	<input checked="" type="checkbox"/>
Mon	10:00	01:00		Outdoors	<input type="checkbox"/>
				Both	<input type="checkbox"/>
Tue	10:00	01:00	<p>Please give further details here (please read guidance note 5)</p>		
Wed	10:00	01:00	<p>AMPLIFIED MUSIC</p>		
Thur	10:00	02:00	<p>State any seasonal variations for entertainment of a similar description to that falling within (e), (f) or (g) (please read guidance note 6)</p>		
Fri	10:00	02:00			
Sat	09:00	02:00	<p>Non standard timings. Where you intend to use the premises for the entertainment of a similar description to that falling within (e), (f) or (g) at different times to those listed in the column on the left, please list (please read guidance note 7)</p>		
Sun	09:00	02:00	<p>CHRISTMAS EVE + NEW YEARS EVE 10:00 - 03:00</p>		

I

Late night refreshment Standard days and timings (please read guidance note 8)			Will the provision of late night refreshment take place indoors or outdoors or both – please tick (please read guidance note 4)	Indoors	<input type="checkbox"/>
				Outdoors	<input type="checkbox"/>
				Both	<input checked="" type="checkbox"/>
Day	Start	Finish			
Mon	23:00	01:00	Please give further details here (please read guidance note 5) HOT FOOD TO BE CONSUMED ON THE PREMISES BY CUSTOMERS AND OFF THE PREMISES BY PEOPLE THAT DRIP IN OR PASSING TRADE.		
Tue	23:00	01:00			
Wed	23:00	01:00	State any seasonal variations for the provision of late night refreshment (please read guidance note 6)		
Thur	23:00	02:00			
Fri	23:00	02:00	Non standard timings. Where you intend to use the premises for the provision of late night refreshment at different times, to those listed in the column on the left, please list (please read guidance note 7) CHRISTMAS EVE + NEW YEARS EVE 10:00 - 03:00		
Sat	23:00	02:00			
Sun	23:00	02:00			

J

Supply of alcohol Standard days and timings (please read guidance note 8)			Will the supply of alcohol be for consumption – please tick (please read guidance note 9)	On the premises	<input type="checkbox"/>
Day	Start	Finish		Off the premises	<input type="checkbox"/>
Mon	10:00	01:00	State any seasonal variations for the supply of alcohol (please read guidance note 6)	Both	<input checked="" type="checkbox"/>
Tue	10:00	01:00			
Wed	10:00	01:00			
Thur	10:00	02:00		Non-standard timings. Where you intend to use the premises for the supply of alcohol at different times to those listed in the column on the left, please list (please read guidance note 7)	
Fri	10:00	02:00			
Sat	09:00	02:00			
Sun	09:00	02:00			

CHRISTMAS EVE + NEW YEARS EVE
10:00 - 03:00

K

Please highlight any adult entertainment or services, activities, other entertainment or matters ancillary to the use of the premises that may give rise to concern in respect of children (please read guidance note 10).

WE CURRENTLY DO NOT HAVE ANY GAMING MACHINES BUT WE MAY GET SOME IN THE FUTURE.

L

Hours premises are open to the public Standard days and timings (please read guidance note 8)			State any seasonal variations (please read guidance note 6)
Day	Start	Finish	
Mon	12:00	23:00	
Tue	12:00	23:00	
Wed	12:00	23:00	
Thur	12:00	23:00	
Fri	12:00	02:00	
Sat	12:00	02:00	
Sun	12:00	23:00	

Non standard timings. Where you intend the premises to be open to the public at different times from those listed in the column on the left, please list (please read guidance note 7)		
<p>CHRISTMAS EVE + NEW YEARS EVE</p> <p>10:00 - 03:00</p>		

Please identify those conditions currently imposed on the licence which you believe could be removed as a consequence of the proposed variation you are seeking.

Please tick as appropriate

- I have enclosed the premises licence
- I have enclosed the relevant part of the premises licence

If you have not ticked one of these boxes, please fill in reasons for not including the licence or part of it below

Reasons why I have not enclosed the premises licence or relevant part of premises licence.

I ONLY HAVE ONE COPY OF THE LICENCE.

M

Describe the steps you intend to take to promote the four licensing objectives:

a) General – all four licensing objectives (b, c, d and e) (please read guidance note 10)

EFFECTIVE AND RESPONSIBLE MANAGEMENT OF PREMISES.
TRAINING AND SUPERVISION OF STAFF.
PROVISION AND MONITORING OF CCTV.
ADOPTION OF BEST PRACTICE GUIDANCE
WORK CLOSELY WITH THE POLICE AND LICENSING AUTHORITY

b) The prevention of crime and disorder

ENSURING CCTV IS IN WORKING ORDER AND STORING FOOTAGE FOR A MINIMUM OF 28 DAYS.
EMPLOYMENT OF SIA LICENSED DOOR STAFF ON BUSY EVENTS.
ROBUST CLEANING PROCEDURES DONE HOURLY IN THE TOILETS AND THE USE OF "BLOCK IT" TO DEAL WITH POTENTIAL DRUG USE.
HAVING A THINK 25 POLICY IN PLACE AS WELL AS A REFUSAL LOG.

c) Public safety

SUITABLE RISK ASSESSMENTS IN REGARDS TO FIRE SAFETY + HEALTH AND SAFETY.
ENSURE ALL FIRE EQUIPMENT IS SERVICED REGULARLY AND WEEKLY TESTING OF ALARM SYSTEM.
ENSURE ALL FOOD SAFETY PAPERWORK IS UP TO DATE + PROCEDURES FOLLOWED.
APPROPRIATE INSTRUCTION, TRAINING AND SUPERVISION OF THOSE EMPLOYED.
PROVISION OF EFFECTIVE CCTV.

d) The prevention of public nuisance

MONITOR NOISE FROM CUSTOMERS OUTSIDE SMOKING AS WELL AS NOISE OF MUSIC + EXTRACTION EQUIPMENT.
OUTSIDE CCTV TO MONITOR CUSTOMERS ARRIVING + LEAVING THE PREMISES.
DISPLAYING A SIGN ASKING TO CONSIDER OUR NEIGHBOURS WHEN OUTSIDE AND WHEN LEAVING THE PREMISES.
APPROPRIATE INSTRUCTION, TRAINING AND SUPERVISION TO PREVENT - INCIDENTS OF PUBLIC NUISANCE + REFUSING ALCOHOL TO THOSE INTOXICATED.

e) The protection of children from harm

LIMITATIONS ON HOURS WHEN CHILDREN CAN BE IN THE PREMISES - NOT PAST 21:00.
ALL CHILDREN MUST BE ACCOMPANIED BY AN ADULT.
SUFFICIENT NUMBER OF STAFF TO SECURE THE PROTECTION OF CHILDREN FROM HARM.
ANY ENTERTAINMENT FOR AN AUDIENCE OVER 18 WILL HAVE STRONG SUPERVISION - ON PROOF OF AGE FOR ENTRY.
THREE MEMBERS OF OUR STAFF HAVE ENHANCED DBS CHECKS AND TWO OF THE THREE WORK WITH CHILDREN IN SCHOOLS. A CHILD SAFE GUARDING POLICY WILL BE IN PLACE.

Checklist:

Please tick to indicate agreement

- I have made or enclosed payment of the fee; or
- I have not made or enclosed payment of the fee because this application has been made in relation to the introduction of the late night levy.
- I have sent copies of this application and the plan to responsible authorities and others where applicable.
- I understand that I must now advertise my application.
- I have enclosed the premises licence or relevant part of it or explanation.
- I understand that if I do not comply with the above requirements my application will be rejected.

IT IS AN OFFENCE, UNDER SECTION 158 OF THE LICENSING ACT 2003, TO MAKE A FALSE STATEMENT IN OR IN CONNECTION WITH THIS APPLICATION. THOSE WHO MAKE A FALSE STATEMENT MAY BE LIABLE ON SUMMARY CONVICTION TO A FINE OF ANY AMOUNT.

Part 5 – Signatures (please read guidance note 12)

Signature of applicant (the current premises licence holder) or applicant's solicitor or other duly authorised agent (please read guidance note 13). **If signing on behalf of the applicant, please state in what capacity.**

Signature	
Date	22/4/2022
Capacity	OWNER

Where the premises licence is jointly held, signature of 2nd applicant (the current premises licence holder) or 2nd applicant's solicitor or other authorised agent (please read guidance note 14). **If signing on behalf of the applicant, please state in what capacity.**

Signature	
Date	
Capacity	

Contact name (where not previously given) and address for correspondence associated with this application (please read guidance note 15)

CHARLIE COLFIELD
THE FORBIDDEN FRUIT
22 GRAND PARADE

Post town	CENTRAL ST LEONARD ON SEA	Post code	TN37 6DN
Telephone number (if any)			

and any premises licence to be granted or varied in respect of this application made by

CHARLIE JAMES COLFIELD
[name of applicant]

concerning the supply of alcohol at

THE FORBIDDEN FRUIT
22 GRAND PARADE
ST LEONARDS ON SEA
TN37 6DN

[name and address of premises to which application relates]

I also confirm that I am entitled to work in the United Kingdom and am applying for, intend to apply for or currently hold a personal licence, details of which I set out below.

Personal licence number

HO20 339
[insert personal licence number, if any]

Personal licence issuing authority

HASTINGS BOROUGH COUNCIL, MURIEL MATTERS HOUSE, BREEDS PL, HASTINGS, TN34 3WY
[insert name and address and telephone number of personal licence issuing authority, if any]

Signed

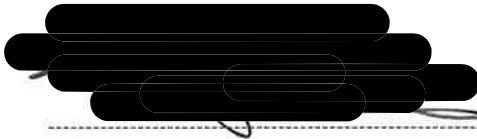

Name (please print)

CHARLIE JAMES COLFIELD

Date

21/04/2022.

UPPER GROUND AND LOWER GROUND FLOOR

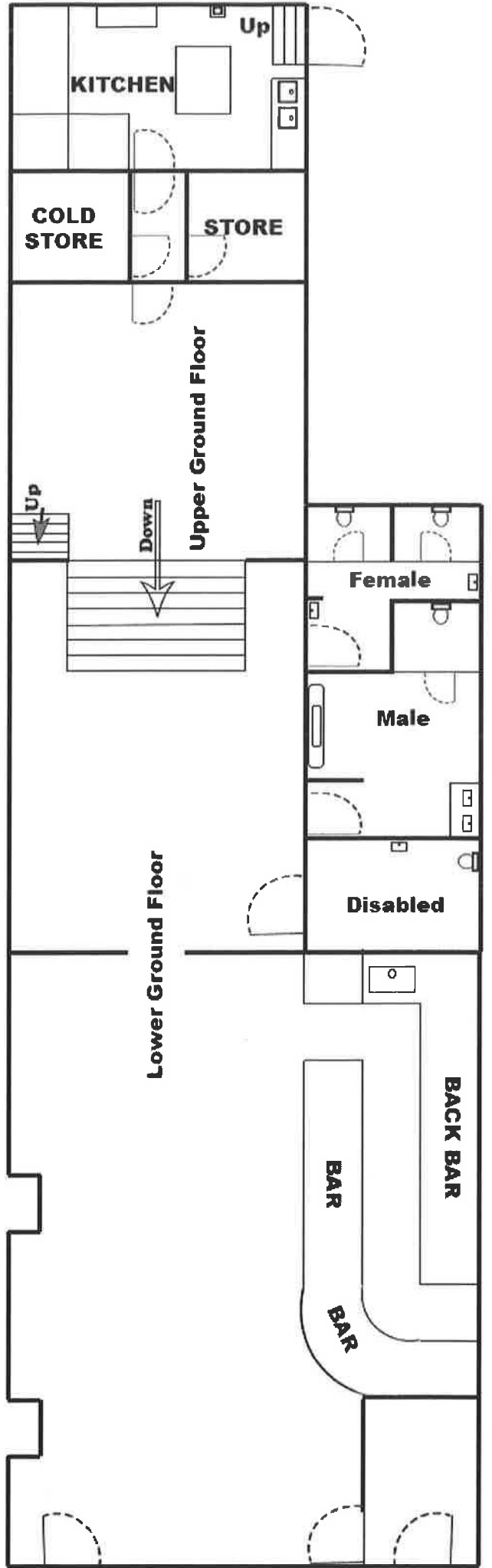



BASEMENT FLOOR

